

Single row taper roller bearings

R00	MA131020	MA/DA131020
-----	----------	-------------

30316 E

Main boundary dimensions (mm)	
d	80
D	170
T	42,5
B	39
C	33

Technical data			
Basic load ratings (kN)	Dyn.	C_r	337
	Stat.	C_{0r}	324
Mass (kg)		4,17	
Cage material		Pressed steel	
Min chamfer dimensions (mm)	r₁	3,0	
	r₂	3,0	
	r₃	2,5	
	r₄	2,5	
Precision class		Normal	
e		0,35	
K		1,69	
Bearing clearance (mm)		-	

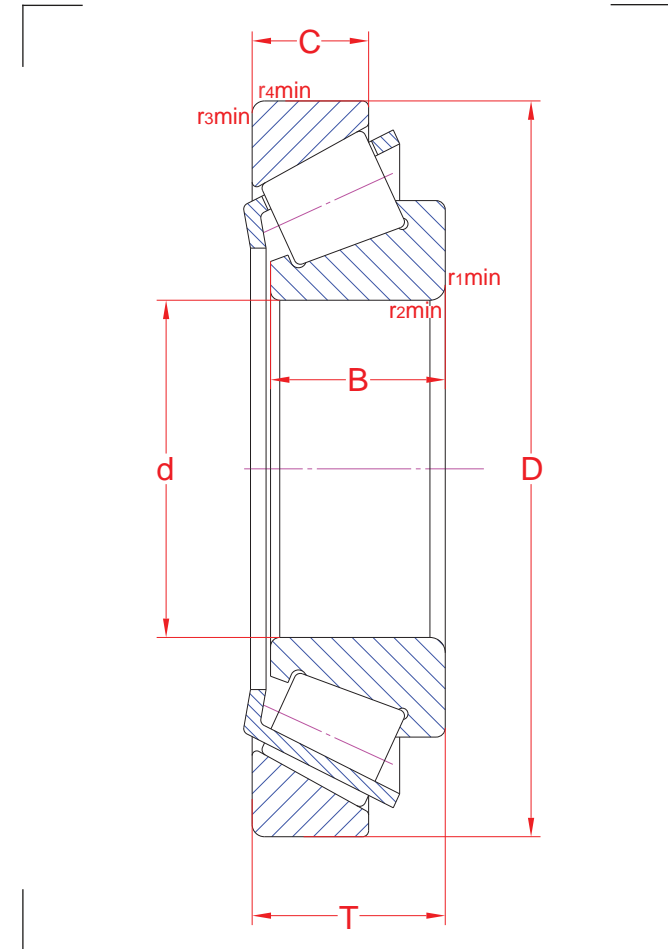

Technical notes

- Through hardened steel for rings and rollers (SAE 52100)
- Reference speed 2840 rpm
- Limiting speed 3500 rpm
- Cage max protrusion 2,450 mm (cup large face side) and 5,150 mm (cup small face side)
- Optimized internal design with reinforced execution
- For general industry purpose

The sketch is for reference only and may not be representative or indicative of the actual product. Sketch scale is free.

Also refer to RKB Affidavit of Conformance for related compliance to International Standards.

Every care has been taken to ensure the accuracy of the information in the present drawing, but no liability can be accepted for any errors or omissions contained herein, or in case losses and/or damages (direct, indirect, consequential) should occur.

RKB Bearing Industries reserves the right of any amendment without notice.