

# Deep groove ball bearings

OV230615

61932 MB

Main boundary dimensions (mm)	
<b>d</b>	160
<b>D</b>	220
<b>B</b>	28

Technical data			
Basic load ratings (kN)	Dyn.	<b>C<sub>r</sub></b>	88
	Stat.	<b>C<sub>0r</sub></b>	97
Mass (kg)		3,5	
Cage material		Brass	
Radius min (mm)	<b>r<sub>1</sub></b>	2,0	
	<b>r<sub>2</sub></b>	2,0	
	<b>r<sub>3</sub></b>	-	
	<b>r<sub>4</sub></b>	-	
Precision class		P0	
<b>e</b>		-	
Bearing clearance (mm)		CN	
Configuration/Design		619/MB	

## Technical notes

- Through-hardened steel for rings and balls (RKB SAE52100)
- Machined brass cage guided on inner ring (suffix MB)
- Speed rating oil lubrication 5746 rpm
- For general industry purpose

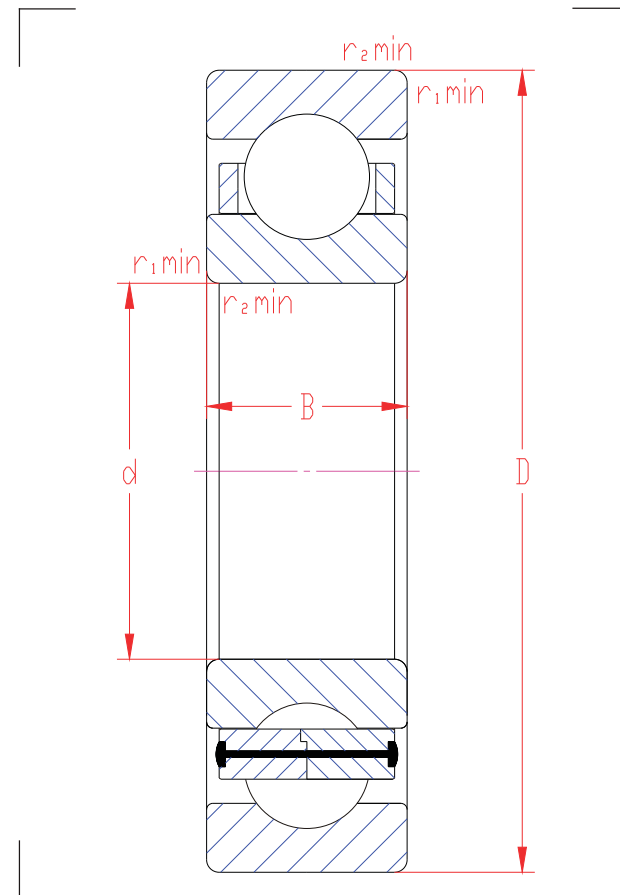

Sketch scale is free.

Also refer to RKB Affidavit of Conformance (LJSA) for related compliance to International Standards.

Every care has been taken to ensure the accuracy of the information in the present drawing but no liability can be accepted for any errors or omissions contained herein, or in case losses and/or damages (direct, indirect, consequential) should occur.

RKB Bearing Industries reserves the right of any amendment without notice.