

Deep groove ball bearings

AB040216

6211 C3

Main boundary dimensions (mm)	
d	55
D	100
B	21

Technical data			
Basic load ratings (kN)	Dyn.	C_r	45
	Stat.	C_{0r}	28,5
Mass (kg)		0,6	
Cage material		Pressed steel	
Radius min (mm)	r_1	1,5	
	r_2	1,5	
Precision class		P0	
Bearing clearance (mm)		C3	
Configuration/Design		62	

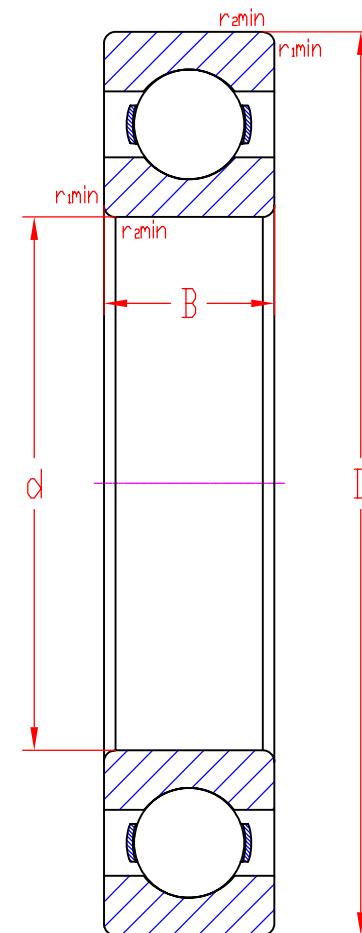

Technical notes

- Through-hardened steel for rings and balls (RKB SAE52100)
- Speed rating oil lubrication 13600 rpm
- For general industry purpose

Sketch scale is free.

Also refer to RKB Affidavit of Conformance (LJSA) for related compliance to International Standards.

Every care has been taken to ensure the accuracy of the information in the present drawing but no liability can be accepted for any errors or omissions contained herein, or in case losses and/or damages (direct, indirect, consequential) should occur.

RKB Bearing Industries reserves the right of any amendment without notice.