

Single row angular contact ball bearings

7317 BEGAM

R00	LT081117	MA/DC081117
-----	----------	-------------

Main boundary dimensions (mm)	
d	85
D	180
B	41

Technical data			
Basic load ratings (kN)	Dyn.	C_r	152
	Stat.	C_{0r}	131
Mass (kg)		4,45	
Cage material		Brass	
Radius min (mm)	r₁	3,0	
	r₂	3,0	
	r₃	1,1	
	r₄	1,1	
Precision class		P6	
e		1,14	
Configuration/Design		73/B/E/GA/M	

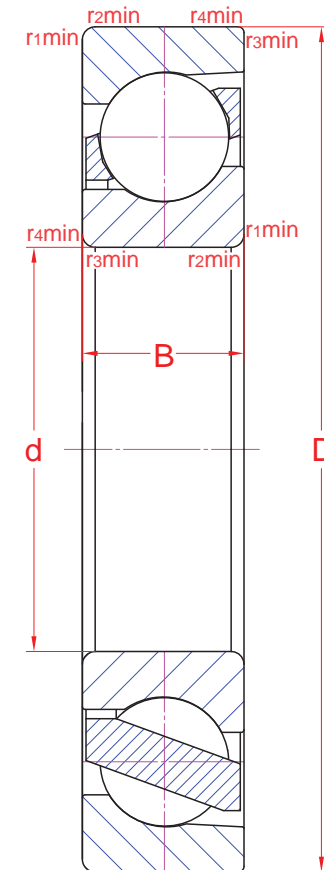

Technical notes

- Reference speed 4000 rpm
- Limiting speed 4600 rpm
- Bearing with a 40° contact angle
- Optimized internal design with reinforced execution
- Machined brass cage guided on rolling elements
- For general industry purpose

Sketch scale is free.

Also refer to RKB Affidavit of Conformance (LJSA) for related compliance to International Standards.

Every care has been taken to ensure the accuracy of the information in the present drawing but no liability can be accepted for any errors or omissions contained herein, or in case losses and/or damages (direct, indirect, consequential) should occur.

RKB Bearing Industries reserves the right of any amendment without notice.