

Self-aligning ball bearings

R00	GR161120	MA121120
-----	----------	----------

2211 KTN2RS

Main boundary dimensions (mm)	
d	55
D	100
B	25

Technical data			
Basic load ratings (kN)	Dyn.	C_r	27,0
	Stat.	C_{Or}	10,4
Mass (kg)		0,7	
Cage material		PA66-GF25	
Min chamfer dimensions (mm)	r_1	1,5	
	r_2	1,5	
	r_3	-	
	r_4	-	
Precision class		P0	
e		-	
Bearing clearance (mm)		CN	

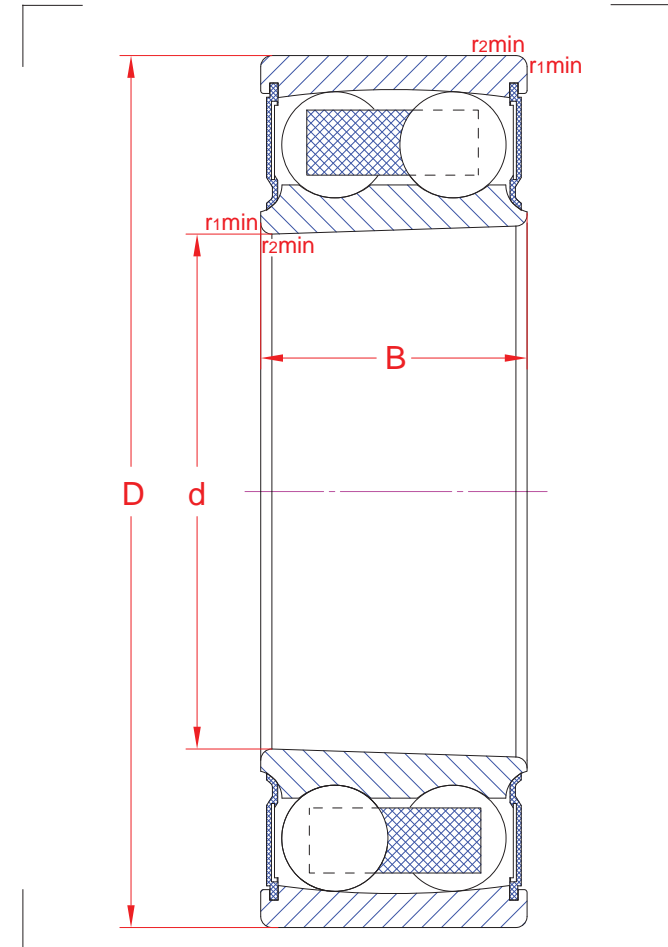

Technical notes
<ul style="list-style-type: none"> - Limiting speed 3700 rpm - Tapered bore, taper 1:12 - Contact seals on both sides - Filled with standard bearing grease - Molded glass fiber-reinforced polyamide cage (PA66-GF25) guided on rolling elements - For general industry purpose

The sketch is for reference only and may not be representative or indicative of the actual product. Sketch scale is free.

Also refer to RKB Affidavit of Conformance for related compliance to International Standards.

Every care has been taken to ensure the accuracy of the information in the present drawing, but no liability can be accepted for any errors or omissions contained herein, or in case losses and/or damages (direct, indirect, consequential) should occur.

RKB Bearing Industries reserves the right of any amendment without notice.